

Technical Specification

Mechanical failing load: 17.8kN

Low frequency dry flashover voltage:
25 kV

Low frequency wet flashover voltage:

Vertical: 12kV

Horizontal: 15 kV

Main Dimensions

H: 81mm D: 76mm R: 11mm

d1: 44mm d2: 17.5mm

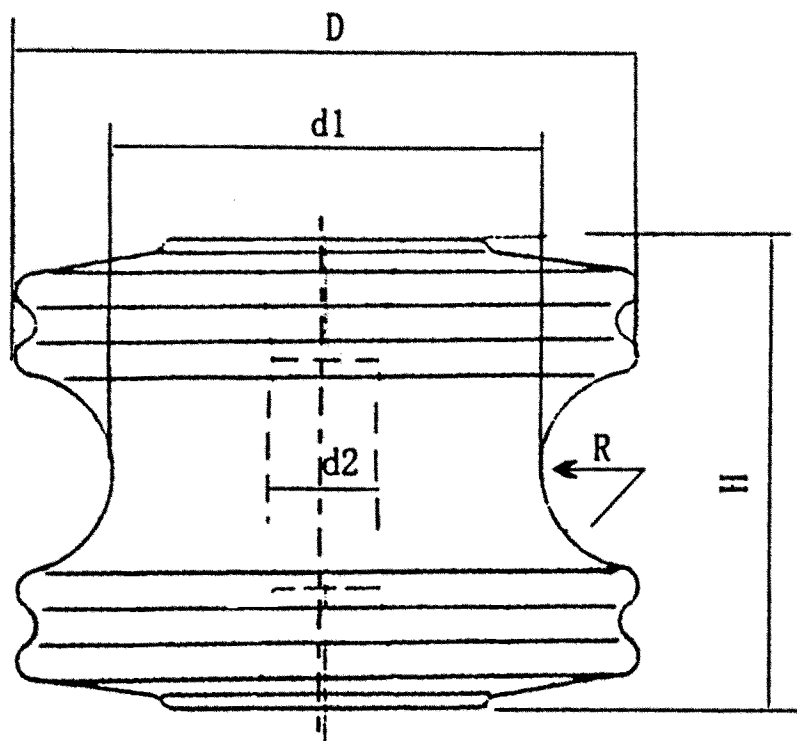

| | | |
|------------------------------|----------------|------|
| ANSI53-3 | 1403 | |
| Spool Porcelain Insulator | WEIGHT | UNIT |
| | 0.6 KG | MM |
| ASSEMBLY DRAWING | PSN COMPONENTS | |